



PRODUCT CATALOGUE
PROFESSIONAL BUILDING PRODUCTS
2018

FLOORING

FLOORING

SELENA SYSTEM OFFERS :

- Systemic solutions for wooden floors, elastic coverings and tiles
- High quality and durability appreciated by installers and end users
- Floor finishing for traditional and modern design floors
- Technical support and advice on the proper selection of products

A stylish and esthetic new floor adds its unique ambience and character to every interior. Artelit & Tytan, owing to its systemic approach and a large portfolio of products, offers professional solutions tailored to every type of flooring project and to the needs of users. Artelit & Tytan flooring systems are characterized by the highest quality and durability standards valued by installers as well as users. It is worth mentioning that all systems are compatible with underfloor heating option. Thanks to worldwide experience and expertise of our technical advisors, Selena guarantees professional support in selecting proper products for every investment.



Parquet Systems

Elastic Floor Covering Systems

Tile Systems for Underfloor Heating

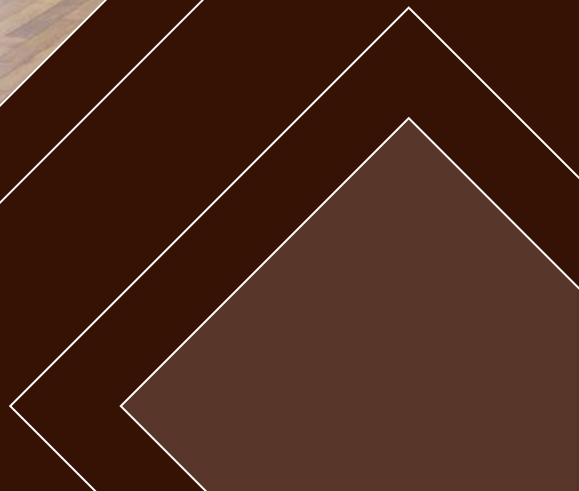

PARQUET SYSTEMS

- 204 SB-210 Solvent Primer
- 204 WB-220 Universal Dispersion Primer
- 204 PB-230 1C PU Primer
- 205 PB-235 Low-Emission 1C PU Primer
- 206 SB-870 Synthetic Adhesive for Parquet
- 206 RB-860 Rubber Adhesive for Parquet
- 207 PB-835 1C PU Adhesive for Parquet
- 207 PB-890 2C PU Adhesive for Parquet
- 208 PB-890 R 2C PU Adhesive for Parquet – Rapid
- 208 HB-810 STP Hybrid Adhesive for Parquet
- 209 HB-820 MS Polymer Adhesive for Parquet
- 210 FS-415 Solvent-Based Parquet Filler
- 210 FW-400 Water-Based Parquet Filler
- 211 S-460 Solvent-Based Priming Varnish
- 211 W-430 Water-Based Primer
- 212 PW-460 2C PU-Based Varnish
- 212 PW-465 2C PU-Based Varnish
- 213 PA-470 1C Acrylic PU-Based Varnish
- 213 PW-480 1C Water PU-Based Varnish
- 214 AB-441 2C Acid Varnish
- 214 KH-440 1C Alkyd Varnish
- 215 OL-610 Fast-Drying Parquet Oil
- 215 OL-610 Oil Hardener
- 215 OL-610 Oil Thinner
- 216 OL-611 Coloured Parquet Oil
- 216 OL-620 Parquet Oil
- 217 OL-650 Oil-Wax for Parquet
- 217 OL-670 Wax
- 218 OL-680 Soap for Oil
- 218 OL-690 Oil Care
- 219 PM-100 Floor Cleaner
- 219 PM-120 Parquet Care

Elastic Floor Covering Systems 221

Tile Systems for Underfloor Heating 241

Parquet Systems

In order to enjoy a long lasting usage of a new floor, a proper preparation of each installation stage is essential:

1. Substrate preparation – make sure that the moisture content of the substrate is not higher than 2% for the cement substrate, 0,5% for the anhydrite substrate, and its strength is at least 25 MPa. Substrates must be clean, seamless and free of defects and cracks.
2. The proper choice of an adhesive with regard to the kind of wood and the size of a glued element – for exotic wood only polyurethane and hybrid adhesives are suitable while for European wood we can choose any type of adhesive. The bigger the glued element, the more resilient and stronger the adhesive should be. This is because bigger elements expand and contract more due to the temperature and humidity fluctuations in the interior.
3. The choice of topcoat finish – oil, varnish or wax – depends on the purpose of the floor and its desired final outlook.

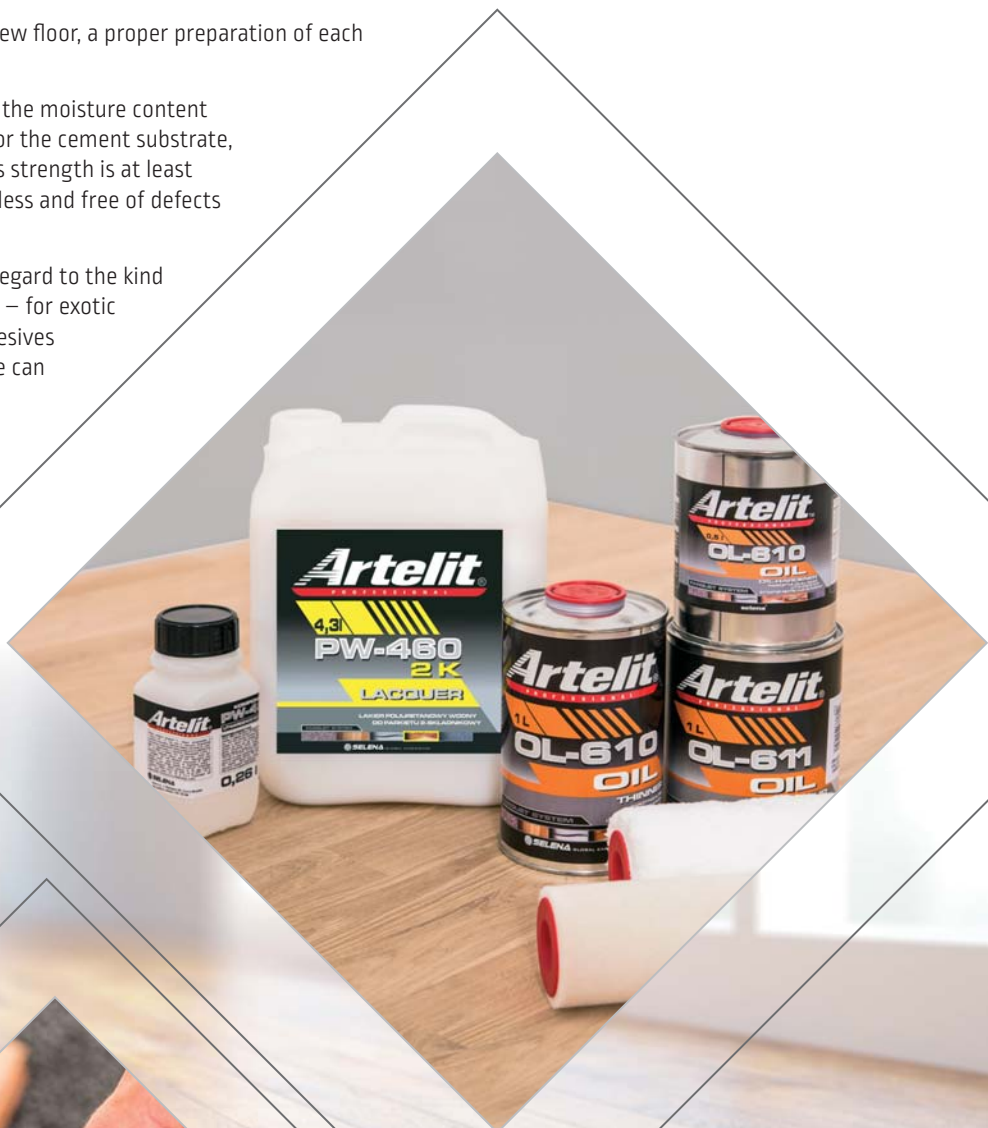

Modern Floors System

The most popular types of floors include modern floors, traditional and sports floors.

Modern floors are characterized by non – standard designs, colour finish, long planks and mixed technologies e.g. oil – varnish topcoats. In this category of floors, Artelit Professional system offers a combination of the following products: primers – depending on the absorptivity of a substrate we recommend the WB-290 or WB-280 Primers, the LC-710 Self-Levelling Compound, the HB-810 Hybrid Adhesive for Parquets, the FS-415 Gap Filler, the OL-611 Coloring Oil, the PW-465 Two-Component Varnish.



Artelit Professional offers a wide choice of colours of oils which follow the current trends in interior design:

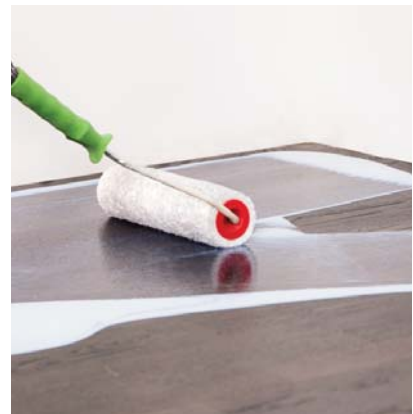

Traditional Floors System

Traditional floors are mainly installed using parquet strips and mosaic parquet. This category also includes the renovations of historical interiors. Here the ideal solution is: WB-290 or WB-280 Primers, LC-735 Cement Screed, PU PB-890 Parquet Adhesive, FS-415 Gap Filler, S-460 Solvent-Based Priming Varnish, PW-480 Topcoat Varnish.

Artelit varnishes are available in all sheens: matt, semi-gloss and high gloss.

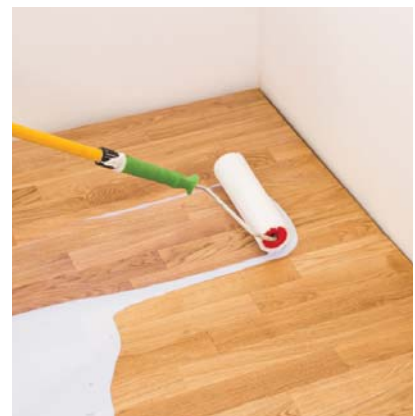

Sports Floors System

Sports floors are mainly installed in sports halls and recreational facilities. Sports flooring systems have to comply with specific requirements. Unlike wooden floors installed in residential interiors or public utility buildings, sports floors must be permanently elastic. They can be divided into three categories: point-elastic, area-elastic and combi-elastic which combine the properties of the former two.

Elasticity is not the only factor in sports flooring but also such parameters as: deformation, ball bounce, friction or the dynamic load. One of the key features of the sports flooring is its anti-slip properties, which ensures the safety of players. These safety standards are defined in the DIN 18032 standard. Artelit Professional varnishes and care products dedicated for sports flooring have been certified in compliance with the DIN 18032 standard which makes them not only durable but also safe for sportsmen.

An example of Artelit Professional System for Sports Floors includes, WB-290 or WB-280 Primer (depending on the substrate absorptivity), LC-720 Anhydrite, Self-Levelling Compound, the HB-810 Hybrid Adhesive for Parquets FS-415 Gap Filler, S-460 Solvent-Based Priming Varnish and KH-440 Alkyd Topcoat Varnish.

The KH-440 Topcoat Varnish and the OL-610 Oil Hold Anti-Slip Attestations for Sports Floorings.

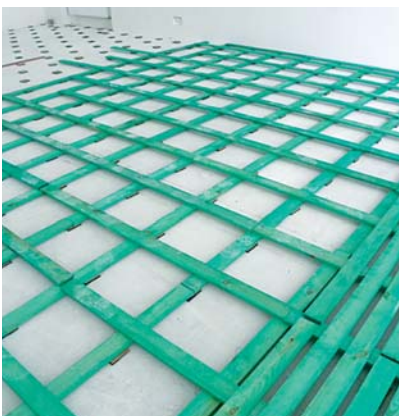

SB-210

Solvent Primer



Synthetic resin primer designed for treatment of absorbent and non-absorbent substrates prior to the application of synthetic resin and rubber based adhesives for parquet (e.g. Artelit RB-860 Rubber adhesive for parquets). Its reddish colour facilitates identification of prepared surfaces.

APPLICATIONS:

- Suitable for most construction substrates, such as concrete, cement and anhydride compounds, and wood

BENEFITS:

- Accelerates drying of adhesives
- Reduces coverage of adhesives
- Reinforces the surface of the substrate
- Penetrates deeper into pores
- Improves resistance of the substrate against water or brush

TECHNICAL PARAMETERS:

- Ready for covering: 12–24 h (at +20°C)
- Coverage: 0,2–0,5 l/m²
- Mixing ratio:
 - 1:1 for absorbent substrates (petroleum, acetone)
 - 1:2 for non-absorbent substrates

Product name	Content	Packaging	Pieces per pallet
SB-210 Solvent Primer	4,5 l	Metal canister	120
	9 l	Metal canister	90

WB-220

Universal Dispersion Primer



Water based primer designed for priming of absorbent and non-absorbent substrates. Especially recommended before application of Dispersion Adhesive for Parquet WB-840 or Adhesives for Floor Coverings: WB-965, WB-975, WB-976, WB-982, WB-981.

APPLICATIONS:

- Priming of absorbent screeds and plastered surfaces
- Improving adhesion to non-absorbent substrates

BENEFITS:

- Reduces adhesive consumption
- Reinforces substrate surface
- Penetrates deeper into pores
- Easy application with a roller or brush

TECHNICAL PARAMETERS:

- Ready for covering: up to 4 h (at +20°C)
- Coverage: 0,2–0,3 l/m²

Product name	Content	Packaging	Pieces per pallet
WB-220 Universal Dispersion Primer	5 l	PE Bucket	108

PB-230

1C PU Primer



One-component polyurethane primer designed for treatment of absorbent and non-absorbent substrates prior to the application of polyurethane based adhesive for parquets (such as ARTELIT PB-830, ARTELIT PB-890). The pink colour facilitates identification of prepared surfaces.

APPLICATIONS:

- Suitable for absorbent and non-absorbent construction substrates

BENEFITS:

- Flexible
- For underfloor heating
- Layer thickness: 2–10 mm
- Water and frost resistant

TECHNICAL PARAMETERS:

- Ready for covering: 24 h (at +20°C)
- Coverage: 0,25–0,45 l/m²
- Mixing ratio:
 - 1 for absorbent substrates (petroleum, acetone)
 - 1:2 for medium absorbent substrates
 - 1:2 for non-absorbent substrates

Product name	Content	Packaging	Pieces per pallet
PB-230 1C PU Primer	4,5 l	Canister	108
	9 l	Canister	80

PB-235

Low-Emission 1C PU Primer



This one-component, fast-drying, polyurethane-based primer ensures even absorption and easy application of the adhesive. Recommended for use prior to the application of PU based parquet adhesives (Artelit PB-830, Artelit PB-890) and STP Hybrid polymer adhesives (Artelit HB-810).

APPLICATIONS:

- For interior and exterior use
- Suitable for absorbent and non-absorbent construction surfaces, such as concrete, wood, anhydride compounds, levelling compounds or wooden-fibre boards
- Ideal for use on dusty surfaces

TECHNICAL PARAMETERS:

- Ready for covering: 90 min (at +20°C)
- Coverage: 0,15–0,4 l/m²

BENEFITS:

- Reduces coverage of adhesives
- Reinforces the substrate
- Binds dust
- Improves resistance of substrate against water
- Fast and easy application
- Suitable for floor heating systems

Product name	Content	Packaging	Pieces per pallet
PB-235	5 l	Canister	120
Low-Emission 1C PU Primer	10 l	Canister	60



CLASSIFICATION MATRIX FOR ADHESIVE PRIMERS

TYPE OF ADHESIVE	ADHESIVE PRIMERS			
	SB-210	WB-220	PB-230	PB-235
SB-870				
RB-860				
PB-835				
PB-890				
PB-890R				
HB-810				
HB-820				

RECOMMENDED

NOT RECOMMENDED

SB-870

Synthetic Adhesive for Parquet



Synthetic resin based adhesive with good adhesion to common construction substrates, such as concrete, cement and anhydride compounds and wooden surfaces. It does not contain water, which makes it ideal for use with moisture-sensitive parquets. Not recommended for exotic wood.

APPLICATIONS:

- Bonding of standard, lamellar and ready-made parquets
- Common and industrial floor mosaics
- Wooden floors, including OSB boards

BENEFITS:

- High initial bonding power
- Very good resistance against ageing and moisture
- Permanently flexible bond
- Water-free
- For floor heating systems
- Fast and easy application with a notched trowel

TECHNICAL PARAMETERS:

- Solid content: 70 ± 2%
- Working time: 10–15 min (at +20°C)
- Coverage: 0,7–1,2 kg/m² (B2–B3 racking)
- Sanding and varnishing: 2–3 days after installation

Product name	Content	Packaging	Pieces per pallet
SB-870 Synthetic Adhesive for Parquet	21 kg	Bucket	21

RB-860

Rubber Adhesive for Parquet



This SBR rubber based adhesive is suitable for bonding various types of flooring on common construction substrates, such as concrete, cement and anhydride compounds, levelling compounds and wood. It does not contain water, which makes it ideal for use with moisture-sensitive parquets. Not recommended for exotic woods.

APPLICATIONS:

- Bonding of standard, lamellar and multi-layer parquets, mosaics and cork
- Especially recommended for moisture-sensitive wood such as beech, birch, oak

BENEFITS:

- High initial bonding strength
- Very good resistance against ageing and moisture
- Permanently flexible bond
- Water-free
- Suitable for floor heating systems

TECHNICAL PARAMETERS:

- Solid content: > 70%
- Working time: 10–15 min (at +20°C)
- Coverage: 0,65–1,3 kg/m² (B2–B3 racking)
- Sanding and varnishing: 3–4 days after installation

Product name	Content	Packaging	Pieces per pallet
RB-860 Rubber Adhesive for Parquet	21 kg	Bucket	33
	12 kg	Bucket	44

PB-835

1C PU Adhesive for Parquet

One-component polyurethane-based adhesive, especially designed for strong and flexible bonding of parquet on absorbent and non-absorbent construction surfaces. Especially good on substrates of ceramic tiles, natural stone and wood. Available in an innovative type of packaging containing 3 x 5 kg packs in separate foils.



APPLICATIONS:

- Bonding of all types of parquets
- Suitable for exotic wood

BENEFITS:

- High initial bonding strength
- Very good resistance against ageing, moisture and temperature changes
- Permanently flexible bond
- Free of solvents and harmful volatile substances
- Water-free
- Suitable for floor heating systems
- Fast and easy application

TECHNICAL PARAMETERS:

- Solid content: > 70 %
- Working time: up to 70 min (at +20°C)
- Coverage:
 - 0,5–0,9 kg/m² (smooth substrates)
 - 0,9–1,7 kg/m² (rough and uneven substrates)
- Sanding and varnishing: 1,5–2 days after installation
- Ready for foot traffic: after 24 h

Product name	Content	Packaging	Pieces per pallet
PB-835 1C PU Adhesive for Parquet	15 kg (3 x 5 kg)	Bucket	55

PB-890

2C PU Adhesive for Parquet

This two-component, water and solvent-free polyurethane adhesive has very good adhesion to absorbent and non-absorbent construction substrates, such as concrete, cement and anhydride compounds, levelling compounds, wood etc.



APPLICATIONS:

- Bonding all types of parquet, especially parquets 10 mm thick
- Wooden planks up to 22 mm, wooden blocks
- Parquets of beech, maple and exotic wood

BENEFITS:

- High strength parameters
- Very good resistance against ageing, moisture and temperature changes
- Permanently flexible bond
- Suitable for floor heating systems
- Fast and easy application

TECHNICAL PARAMETERS:

- Solid content: 100%
- Working time: < 90 min (at +20°C)
- Coverage: 0,7–1,5 kg/m² (smooth substrates)
- Sanding and varnishing: 3 days after installation
- Ready for foot traffic: after 24 h

Product name	Content	Packaging	Pieces per pallet
PB-890	9 + 1 kg	Bucket + bottle	55
2C PU Adhesive for Parquet	4,5 + 0,5 kg	Bucket + bottle	80

PB-890 R

2C PU Adhesive for Parquet – Rapid

This two-component, water and solvent-free adhesive has very good adhesion to absorbent and non-absorbent construction substrates, such as concrete, cement and anhydride compounds, levelling compounds, wood etc. To increase adhesion, use ARTELIT Polyurethane primer PB-235 or PB-230.



APPLICATIONS:

- Bonding all types of parquet, especially parquets 10 mm thick
- Wooden planks up to 22 mm, wooden blocks
- Parquets of beech, maple and exotic wood

TECHNICAL PARAMETERS:

- Working time: < 60 min (at +20°C)
- Sanding: after 72 h
- Final strength: 3 days
- Coverage: 0,7–1,5 kg/m²

BENEFITS:

- Working time – up to 60 min
- Easy spreading
- Very good adhesion
- Highly flexible bond
- Excellent resistance against moisture and ageing
- Suitable for floors with floor heating systems

Product name	Content	Packaging	Pieces per pallet
PB-890 R	9 + 1 kg	Bucket + bottle	55
2C PU Adhesive for Parquet – Rapid	4,5 + 0,5 kg	Bucket + bottle	80

HB-810

STP Hybrid Adhesive for Parquet

Adhesive based on a hybrid polymer, suitable for bonding of various types of flooring. It does not contain isocyanides, solvents or water.



APPLICATIONS:

- Ideal for installation of parquets and wooden floors
- Recommended also for difficult types of wood, such as: beech, maple, exotic wood and all types of wood sensitive to moisture

TECHNICAL PARAMETERS:

- Solid content: 90%
- Working time: < 90 min (at +20°C)
- Coverage: 0,65–1,2 kg/m² (depending on the substrate and spreader type)
- Sanding and varnishing: 3 days after installation
- Final strength: 7 days

BENEFITS:

- Very good adhesion
- High torsional strength
- Very good resistance against ageing, moisture and temperature changes
- Permanently flexible bond
- Suitable for floor heating systems
- Fast and easy application



Product name	Content	Packaging	Pieces per pallet
HB-810 STP Hybrid Adhesive for Parquet	15 kg	Bucket	44

HB-820

MS Polymer Adhesive for Parquet



Parquet adhesive based on MS polymer, does not contain isocyanides, solvents or water. It adheres perfectly to most substrates such as wood, concrete and stone.

APPLICATIONS:

- Bonding traditional parquet, boards, laminated parquet
- Resin-impregnated parquet flooring and varnished parquet
- Recommended for European and exotic parquet (teak, bamboo, etc.)

BENEFITS:

- Very good adhesion
- Very good resistance against ageing, moisture and temperature changes
- Flexible bond
- Suitable for floor heating systems
- Fast and easy application

TECHNICAL PARAMETERS:

- Solid content: 90%
- Working time: < 90 min (at +20°C)
- Coverage: 0,8–1,4 kg/m² (depending on the substrate and spreader type)
- Sanding and varnishing: 3 days after installation
- Final strength: 7 days

Product name	Content	Packaging	Pieces per pallet
HB-820 MS Polymer Adhesive for Parquet	15 kg	Bucket	44

CLASSIFICATION MATRIX FOR PARQUET ADHESIVES

TYPE OF PARQUET	SB-870	RB-860	PB-835	PB-890	PB-890R	HB-810	HB-820*
Oak							
Ash							
Beech							
Acacia							
Cherry							
Hornbeam							
Sycamore							
Fir							
Larch							
Pine							
Spruce							
Merbau							
Teak							
Badi							
Kempas							
Iroko							
Dousiie							
Jotoba							
Lapacho							
Guatambu							
Sucupira							
Amarant							
Bambus							
Tauri							
Padouk							
Kotibe							
Palisander							
Mahagony							
Kosipo							
Traditional mosaic							

* HB-820 up to 60 cm solid wood and laminated board.

RECOMMENDED

NOT RECOMMENDED

FS-415

Solvent-Based Parquet Filler



Solvent-Based Parquet Filler recommended for filling joints with the width up to 2 mm.

APPLICATIONS:

- Ideal for all types of parquet and wooden floors

BENEFITS:

- Very fast drying
- Ready for covering
- Very good sandability
- Excellent filling properties
- Very good adhesion to edges
- For immediate use

TECHNICAL PARAMETERS:

- Coverage/layer: 0,05–0,10 l/m²
- Drying time at +23°C/ 50% r.h.:
- 15–30 min for one layer (depending on the size of the joint, temperature and vaporization)
- Application with stainless steel knife

Product name	Content	Packaging	Pieces per pallet
FS-415	10 l	Tin bucket	60
Solvent-Based Parquet Filler	5 l	Tin bucket	120

FW-400

Water-Based Parquet Filler



Water-Based Parquet Filler recommended for filling joints with the width up to 2 mm.

APPLICATIONS:

- Ideal for all types of parquet and wooden floors

BENEFITS:

- Very fast drying
- Very good sandability
- Excellent filling properties
- Can be mixed with sawdust of all types of wood
- For immediate use

TECHNICAL PARAMETERS:

- Coverage/layer: 0,05–0,07 l/m²
- Drying time at +23°C/ 50% r.h.:
- 30–60 min for one layer (depending on the joint size, temperature and vaporization)
- Application stainless steel filler knife

Product name	Content	Packaging	Pieces per pallet
FW-400 Water-Based Parquet Filler	5 l	Canister	96

S-460

Solvent-Based Priming Varnish

One-component solvent-based priming varnish recommended for use prior to the application of top coating on all types of parquet and wooden floors.



APPLICATIONS:

- All types of parquet and wooden floors
- Especially suitable for exotic woods and old floors
- Seek technical advice when applying the product on smoke oak or strongly absorbent types of wood

BENEFITS:

- Fast drying
- Warm grain accentuation
- No edge gluing
- For immediate use

TECHNICAL PARAMETERS:

- Coverage/ layer: 0,08–0,10 l/m²
- Drying time at +23°C/ 50% r.h.:
 - second layer after 1 h
 - varnishing after 2–3 h
- Maximum time for application of top coating: 18 h
- Application with a roller or stainless steel knife

Product name	Content	Packaging	Pieces per pallet
S-460 Solvent-Based Priming Varnish	5 l	Canister	128

W-430

Water-Based Primer

One-component water-based primer recommended for use prior to the application of top coating on all types of parquet and wooden floors.



APPLICATIONS:

- All types of parquet and wooden floors
- Not suitable for direct use on smoke oak or on exotic and fruit-tree wood (in such cases, we recommend using Artelit primer S-460 first)

BENEFITS:

- Fast drying
- High content of dry matter
- Reduced edge gluing
- For immediate use

TECHNICAL PARAMETERS:

- Coverage/ layer: 0,1–0,15 l/m²
- Drying time at 23°C/ 50% r.h.:
 - 2 h after application with a roller
 - 30 min after application with a spreader
- Maximum time for application of the top coating: 12 h
- Application with a roller or stainless steel knife

Product name	Content	Packaging	Pieces per pallet
W-430 Water-Based Primer	5 l	Canister	128

PW-460

2C PU-Based Varnish

Two-component parquet varnish based on PU resin in water dispersion, available in gloss, semi-gloss and matt.



APPLICATIONS:

- Provides optimal protection of parquet and other wooden floors in heavy traffic areas
- Not suitable for direct use on smoke oak or on exotic and fruit-tree wood (in such cases, we recommend using Artelit primer S-460 first)

BENEFITS:

- NMP-free
- Easy application with a roller
- High saturation of coating
- High mechanical resistance

TECHNICAL PARAMETERS:

- Mixing ratio: 10:1
- Coverage/ layer: 0,1–0,15 l/m²
- Pot life: 2 h
- Drying time at +23°C/ 50% r.h.:
 - second layer after 4–6 h
 - careful use after 48 h
 - final hardness after 7–10 days

Product name	Content	Packaging	Pieces per pallet
FS-415	4,3 l – Varnish	Canister	60
Solvent-Based Parquet Filler	0,26 l – Hardener	Bottle	120

PW-465

2C PU-Based Varnish

Two-component parquet varnish based on PU resin in water dispersion, available in gloss, semi-gloss and matt. One of the key features of the varnish is anti-slip properties according to safety standards defined in the DIN 18032 standard.



APPLICATIONS:

- Provides an optimal protection of parquet and other wooden floors in heavy traffic areas
- Suitable for floors exposed to very high stress
- Not suitable for direct use on smoke oak or on exotic and fruit-tree wood (in such cases, we recommend using Artelit primer S-460 first)

BENEFITS:

- NMP- free
- Long pot life
- High filling power
- Short curing time
- Easy application with a roller

TECHNICAL PARAMETERS:

- Mixing ratio: 10:1
- Coverage/ layer: 0,1–0,15 l/m²
- Pot life: 3 h
- Drying time at +23°C/ 50% r.h.:
 - second layer after 4–6 h
 - careful use after 24 h
 - final hardness after 7 days

Product name	Content	Packaging	Pieces per pallet
PW-465 2C PU-Based Varnish	4,5 l – Varnish	Canister	128
	0,6 l – Hardener	Bottle	128

PA-470

1C Acrylic PU-Based Varnish

One-component parquet varnish based on a PU-acrylate resin, available in semi-gloss.



APPLICATIONS:

- Provides optimal – high quality and ecological – protection of parquets and other wooden floors in residential areas
- Not suitable for direct use on smoke oak or on exotic and fruit-tree wood (in such cases, we recommend using Artelit primer S-460 first)

BENEFITS:

- Free of NMP
- Easy application with a roller
- For residential areas
- Minimum negative impact on wood
- Good resistance against shoe heels and scratching

TECHNICAL PARAMETERS:

- Coverage/ layer: 0,1–0,15 l/m²
- Drying time at +23°C/ 50% r.h.:
 - second layer after 3–5 h
 - careful use after 48 h
 - final hardness after 7–10 days

Product name	Content	Packaging	Pieces per pallet
PA-470	5 l	Canister	120
1C Acrylic PU-Based Varnish	10 l	Canister	60

PW-480

1C Water PU-Based Varnish

One-component parquet varnish based on a PU-resin dispersed in water, available in gloss, semi-gloss and matt.



APPLICATIONS:

- Provides optimal – high quality and ecological – protection of parquets and other wooden floors in high traffic areas
- Not suitable for direct use on smoke oak or on exotic and fruit-tree wood (in such cases, we recommend using Artelit primer S-460 first)

BENEFITS:

- Free of NMP
- Easy application with a roller
- Minimum negative impact on wood

TECHNICAL PARAMETERS:

- Coverage/ layer: 0,1–0,15 l/m²
- Drying time at +23°C/ 50% r.h.:
 - second layer after 3–5 h
 - careful use after 48 h
 - final hardness after 7–10 days

Product name	Content	Packaging	Pieces per pallet
PW-480 1C Water PU-Based Varnish	5 l	Canister	128

AB-441

2C Acid Varnish



Two-component acid curing varnish dedicated for use in high traffic areas, on floors and stairs.

APPLICATIONS:

- Especially developed for interior wooden surfaces
- Suitable for floors and stairs thanks to its high abrasion resistance

BENEFITS:

- Very high abrasion resistance
- Quick curing
- High solid content
- Application with a roller, metal trowel or spray (airless or cup spray gun is also possible)

TECHNICAL PARAMETERS:

- Coverage/ layer: 0,1–0,15 l/m²
- Drying time at +23°C/ 50% r.h.:
 - second layer after 3–4 h
 - careful use after 24 h
 - final hardness after 7–10 days

Product name	Content	Packaging	Pieces per pallet
FS-415	4,5 l – Varnish	Canister	60
Solvent-Based Parquet Filler	0,45 l – Hardener	Bottle	120

KH-440

1C Alkyd Varnish



One-component sealing coat based on a high-quality urethanised alkyd in mild (de-aromatised) solvents.

APPLICATIONS:

- Sealing of all parquet, wooden, and cork floors
- Suitable also for problematic floors such as parquet flooring installed on floor heating, sports floors, industrial parquet flooring, wood-block paving

BENEFITS:

- Anti-slip
- High solid content
- Easy-to-apply

TECHNICAL PARAMETERS:

- Coverage/ layer: 0,08–0,1 l/m²
- Drying time at +23°C/ 50% r.h.:
 - second layer after 14–16 h
 - careful use after 48 h
 - final hardness after 10–14 days

Product name	Content	Packaging	Pieces per pallet
KH-440 1C Alkyd Varnish	5 l	Bucket	120
	10 l	Bucket	60

OL-610

Fast-Drying Parquet Oil



Fast-drying oil which protects and finishes wooden surfaces. To improve mechanical and chemical resistance of the floor (and to achieve faster drying as well), we recommend to mix it with the OL-610 Hardener in the ratio of 10:1.

APPLICATIONS:

- Designed for parquets and other wooden floors

BENEFITS:

- Based on natural oil
- High solid content
- Free of solvents according to TRGS 617
- Easy and fast application with a roller

TECHNICAL PARAMETERS:

- Coverage/ layer: 0,025–0,04 l/m²
- Drying time at +23°C/ 50% r.h.:
 - second layer after 1 h
 - coating with water-based varnish after 24 h
 - coating with solvent-based varnish after 48 h

Product name	Content	Packaging	Pieces per pallet
OL-610 Fast-Drying Parquet Oil	2,5 l	Can	105

OL-610

Oil Hardener



Isocyanide-based hardener for OL-610 Fast-drying Parquet Oil.

BENEFITS:

- Mixes easily with OL-610
- Improves mechanical and chemical resistance of the floor
- Speeds up drying

TECHNICAL PARAMETERS:

- Mixing ratio: 10 parts of OL-610 and 1 part hardener OL-610
- Pot life: 2 h at +23°C/ 50% r.h.

Product name	Content	Packaging	Pieces per box
OL-610 Oil Hardener	0,5 l	Metal can	24

OL-610

Oil Thinner

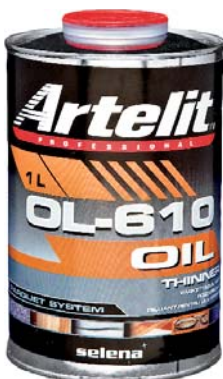

Thinner compatible with varnishes KH-440, AB-441 or the oil line. Also suitable for cleaning of tools or polluted surfaces. Improves penetration of varnish or oil into wood, but reduces the content of dry matter.

BENEFITS:

- Thinned materials are more fluid and penetrate better and deeper into timber structure
- Free of aromatic substances

Product name	Content	Packaging	Pieces per box
OL-610 Oil Thinner	1 l	Metal can	12

OL-611

Coloured Parquet Oil

High quality interior coloured oil designed for parquets and other new or original wooden floors. To protect the colour, the floor can also be treated with the 2C water-based varnish AB-441, Urethane-Alkyd Varnish KH-440 or Oil-Wax OL-650. Available colours: teak, smoked oak, olive, white, grey, and walnut.

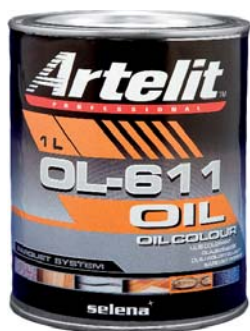

BENEFITS:

- Enriches the wood with a beautiful colour
- Based on natural oil
- Wide colour range
- Fast and easy application with a roller
- Colour shades can be mixed together to create your own colour tone

TECHNICAL PARAMETERS:

- Coverage/ layer: 0,025–0,04 l/m²
- Drying time at +23°C/ 50% r.h.: 1 h
 - second layer after 48 h
 - coating with water-based varnish after 3 days
 - coating with solvent-based varnish after 10–14 days
 - careful use after 3 days (2c oil after 1 day)
 - final hardness after 10 days (2c oil after 3 days)

Oil Colours:



Product name	Content	Packaging	Pieces per box	Pieces per pallet
OL-611 Coloured Parquet Oil	1 l	Metal can	11	396

OL-620

Parquet Oil

Oil for surface finish and impregnation of wooden floors in interiors. The product is based on natural oils and is characterised by its high solid content and easy application.



APPLICATIONS:

- For wooden floors and parquets
- Suitable for hard and soft wood

BENEFITS:

- Based on natural oil
- High solid content
- Easy application with a roller
- Penetrates easily into the substrate due to low density

TECHNICAL PARAMETERS:

- Coverage/ layer: 0,07–0,1 l/m²
- Drying time at +23°C/ 50% r.h.:
 - second layer after 60 min
 - careful use after 3 days
 - final hardness after 8–10 days

Product name	Content	Packaging	Pieces per pallet
OL-620 Parquet Oil	5 l	Canister	128

OL-650

Oil-Wax for Parquet

Mixture of oil and wax which forms a hard layer after application. Designed for surface finish of parquets and wooden floors, making them more resistant against dirt and spots. Also suitable for treatment of floors coated with Coloured Parquet Oil OL-611.



APPLICATIONS:

- For parquets and wooden floors
- Suitable for hard and soft wood
- Ideal for heavy traffic areas: corridors, industrial parquets

BENEFITS:

- Based on natural oils, resins and waxes
- Easy application with a roller
- Simple maintenance

TECHNICAL PARAMETERS:

- Coverage/ layer: 0,05–0,08 l/m²
- Drying time at +23°C/ 50% r.h.:
 - second layer after 24 h
 - careful use after 3 days
 - final hardness after 10–14 days

Product name	Content	Packaging	Pieces per pallet
OL-650 Oil-Wax for Parquet	5 l	Bucket	90

OL-670

Wax

Floor maintenance product based on natural wax and mild solvents.

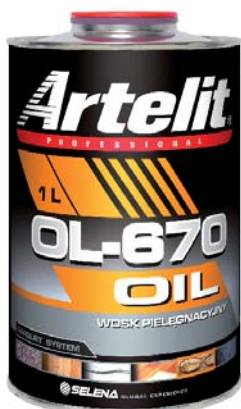

APPLICATIONS:

- Maintenance of wooden floors treated with OL-650 Oil-Wax or other Artelit oils

BENEFITS:

- Easy to apply
- Does not contain preservatives
- Water-resistant
- Antistatic and anti-slip

TECHNICAL PARAMETERS:

- Coverage: 30–40 ml/m² for a single application
- Drying time: 1–3 h

Product name	Content	Packaging	Pieces per box	Pieces per pallet
OL-670 Wax	1 l	Metal can	12	432

OL-680

Soap for Oil

A special soap designed for cleaning and maintaining oiled and waxed wooden surfaces. An additional care product (maintenance oil, wax) must be applied at appropriate intervals, as required by care instructions.



APPLICATIONS:

- Suitable for cleaning oiled and waxed wooden surfaces

BENEFITS:

- Highly concentrated soap combination
- No added scents or preservatives
- Lipid regulating effect
- Based on natural vegetable oils

TECHNICAL PARAMETERS:

- Consumption: approx. 100 ml per 10 l of water
- Diluter/ cleaning agent: water immediately after use
- Application: standard mops
- Drying time: 30–60 min

Product name	Content	Packaging	Pieces per pallet
OL-680 Soap for Oil	5 l	Metal can	90

OL-690

Oil Care

Floor maintenance product based on natural oils and mild solvents, especially designed for oiled wooden floors.



APPLICATIONS:

- Maintenance of oiled wooden floors
- Not suitable for waxed floors

BENEFITS:

- Free of chlorinated solvents and aromatics
- Free of preservatives
- Easy to use

TECHNICAL PARAMETERS:

- Diluter/ cleaning agent: OL-610 Thinner
- Coverage: 20–40 ml/m² per application
- First careful use: after ca. 24 h
- Drying time: 12 h

Product name	Content	Packaging	Pieces per pallet
OL-690 Oil Care	5 l	Metal can	90

PM-100

Floor Cleaner



Highly efficient, water-based cleaner for all types of water-resistant flooring.

APPLICATIONS:

- Cleaning varnished parquets, ready-made parquets, linoleum, PVC or laminate flooring

BENEFITS:

- Highly efficient
- Enhances floor appearance

TECHNICAL PARAMETERS:

- Consumption: ca. 0,1 l/7-8 l water
- Drying time: 30-60 min
- Application with a cloth

Product name	Content	Packaging	Pieces per box	Pieces per pallet
PM-100 Floor Cleaner	0,75 l	Bottle	15	432

PM-120

Parquet Care



Water-based product suitable for maintenance of all water-resistant floors. Forms a protective layer resistant to scratches and dirt. PM-120 Parquet Care does not require polishing.

APPLICATIONS:

- Maintenance of varnished parquets, ready-made parquets, as well as linoleum and PVC coverings
- Suitable for sports surfaces in accordance with DIN 18032-2

BENEFITS:

- Forms a protective layer
- High resistance against abrasion and scratching

TECHNICAL PARAMETERS:

- Coverage/ layer: 0,03-0,05 l/m²
- Drying time at +23°C/ 50% r.h.:
 - further treatment after 2 h
 - careful use after 2-4 h
- Application with a cloth

Product name	Content	Packaging	Pieces per box	Pieces per pallet
PM-120 Parquet Care	0,75 l	Bottle	15	432

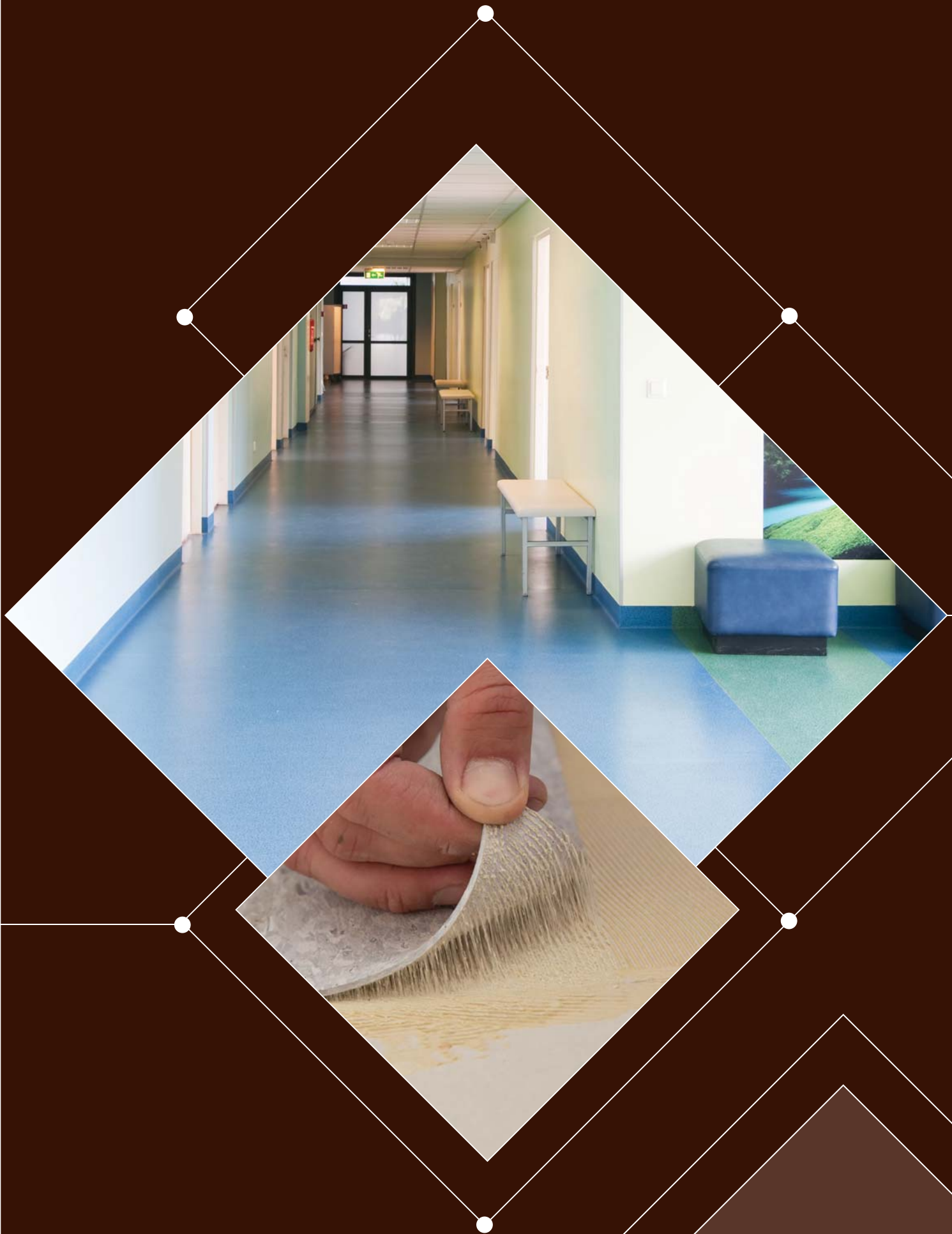

ELASTIC FLOOR COVERING SYSTEMS

- 226 WB-280 Primer for Non-Absorbent Substrates
- 226 WB-290 Primer for Absorbent Substrates – Concentrate
- 226 EB-270 Epoxy Primer
- 228 RC-001 Emergency Repair Compound
- 228 LC-700 Sturdy Levelling Compound for Repairs
- 229 LC-702 Sturdy Liquid Levelling Compound
- 229 LC-705 Self-Levelling Compound up to 5 mm
- 230 LC-710 Classic Self-Levelling Compound up to 10 mm
- 231 LC-720 Anhydride Self-Levelling Compound up to 20 mm
- 231 LC-735 Cement Screed up to 35 mm
- 232 LC-760 Cement Screed up to 60 mm
- 234 WB-965 Carpet Adhesive
- 234 WB-975 PVC Adhesive
- 235 WB-976 Linoleum Adhesive
- 235 WB-977 Conductive Adhesive for Floor Coverings
- 236 WB-981 Special Universal Adhesive for Floor Coverings
- 236 WB-982 Universal Dispersion Adhesive for Floor Coverings
- 237 WB-984 Fixing Adhesive
- 237 WB-986 Anti-Slip Fluid for Carpet Coverings
- 238 PB-985 2C PU Adhesive for Elastic Coverings
- 238 SB-510 Universal Contact Adhesive

Parquet Systems 199

Tile Systems for Underfloor Heating 241

Elastic Floor Covering Systems

Elastic Floor Covering Systems enjoy growing popularity owing to their diversified designs, modern materials and the comfort of usage. Elastic carpets are installed mainly in the public utility buildings. Individual investors appreciate their qualities, especially in children's rooms and bedrooms.

The durability of a carpet depends, among others, on the proper choice of its type and the professional performance of its installation.

Extra attention should be paid to:

1. The preparation of substrate which should be even to avoid irregularities. In case of random defects of the substrate, the LC-700 Levelling Compound should be applied. Minimal strength of the substrate should be 16 MPa and its moisture content should not exceed 2% for cement substrates and 0,5% for anhydrite substrates.
2. The proper choice of an adhesive depends on the type of carpet and on the place where it is used. Artelit Professional system provides a series of products dedicated for various carpets.

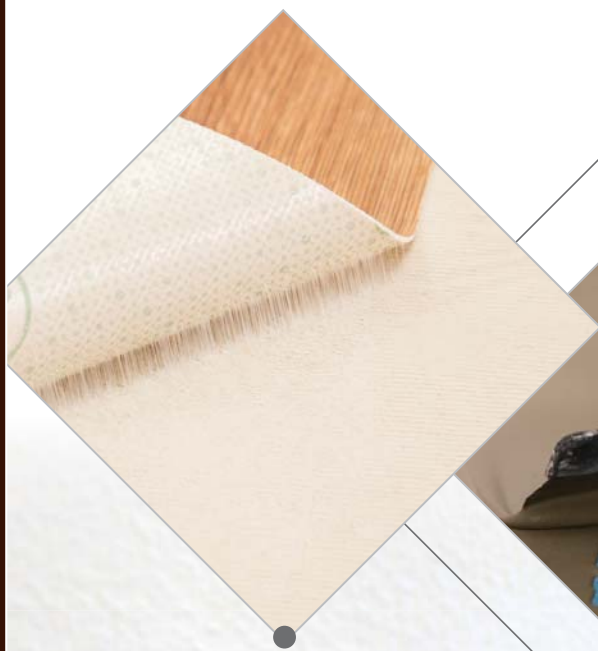
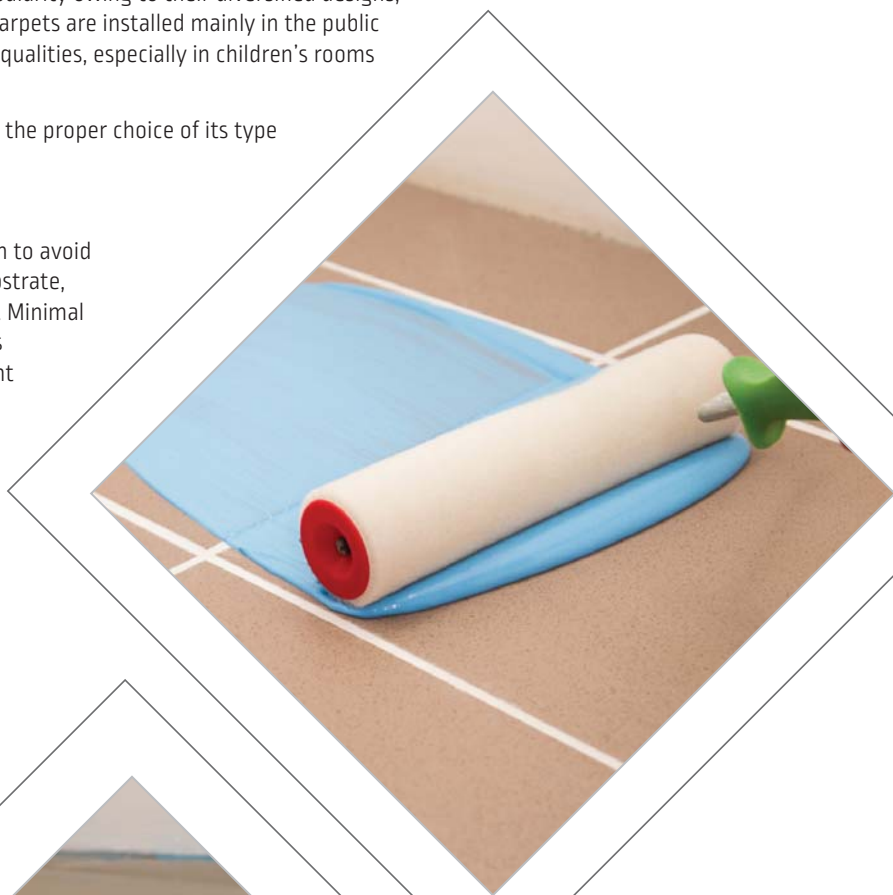

Modern Elastic Floor System

Modern Elastic Floor System includes mainly technologically advanced materials such as carpet tiles, and LVT (Luxury Vinyl Tiles). Carpet tiles are extremely popular in offices because of the ease with which the specific elements can be exchanged. As for the LVT tiles, they ensure long-term usage and they come in a rich choice of patterns and designs. Artelit Professional system meets all the requirements of the proper installation of this type of carpets. Here we recommend the WB-290 or WB-280 Primers depending on the absorptivity of the substrate. LC-700 Levelling Compound, LC-705 Self-Leveling Compound, WB-981, WB-984, or WB-986 adhesives.

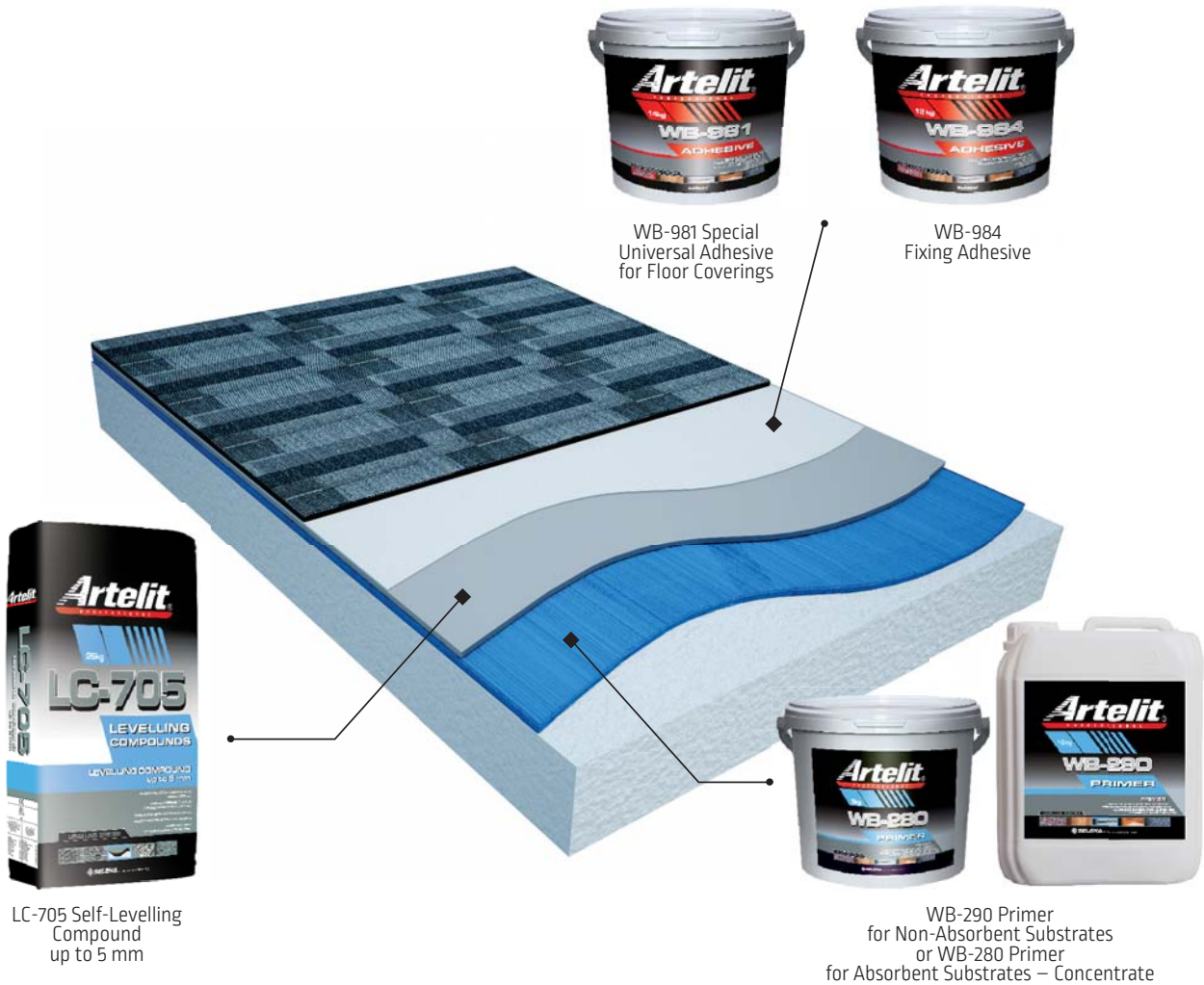

Traditional Elastic Floor System

Traditional Elastic Floor are mainly fitted carpets and PVC floor coverings which are commonly used in schools, offices, hospitals and residential buildings. Investors choose them thanks to their esthetic values, the comfort of usage and the ease and quickness of installation. The most commonly used Artelit Professional system for traditional carpets includes: WB-280 or WB-290 Primers (depending on the absorptivity of the substrate), LC-700 Levelling Compound, LC-705 Self-Levelling Compound, WB-965 Carpet Adhesive or WB-975 PVC Adhesive.



Sports Carpets System

Sports carpets are installed mainly in the modern sports halls in compliance with the DIN 1803-2 standard. They have to meet the requirements of elasticity and resilience. The installation of the sports floor starts with the substrate preparation and the installation of the wooden grating which is then covered with panels to which the carpet is eventually glued. Artelit Professional system offers the following products for the installation of the sports carpets: WB-280 or WB-290 depending on the absorptivity of the substrate, LC-705 Self-Levelling Compound and WB-981 Adhesive.

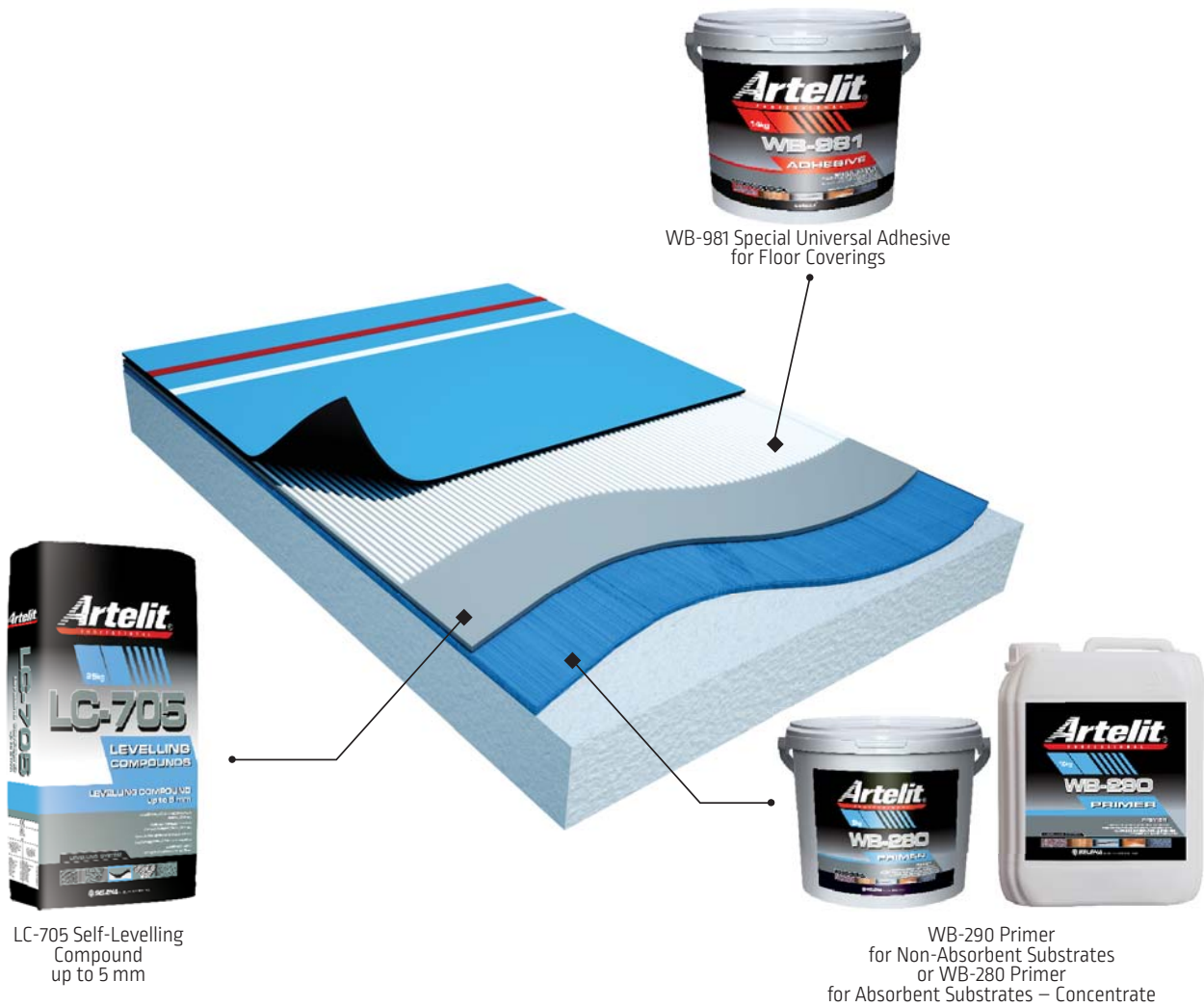

WB-280

Primer for Non-Absorbent Substrates



One-component primer designed for smooth and non-absorbent substrates.

APPLICATIONS:

- Ideal for application on old ceramic tiles, PVC, CV flooring, linoleum, natural stone, terrazzo, bitumen substrates, original epoxy paints, OSB boards, wooden subfloor, etc.
- Not recommended for surfaces permanently exposed to water
- For interior and exterior use

BENEFITS:

- EC1 Plus
- Fast-drying, ready to use
- Solvent-free
- Resistant to water
- For walls and floors
- For floor heating systems
- Free of unpleasant smell
- Application with a roller or brush

TECHNICAL PARAMETERS:

- Coverage/layer: 0,1–0,13 l/m², undiluted
- Application temperature: min +15°C
- Drying time at +20°C/ 50% r.h.: 0,5–1 h
- Temperature resistance: < +50°C

Product name	Content	Packaging	Pieces per pallet
WB-280	5 l	Bucket	90

WB-290

Primer for Absorbent Substrates – Concentrate



Primer for absorbent substrates which reduces absorption of water, increases adhesion of the substrate and protects dry construction materials, e.g. plaster substrates, against moisture. When mixed with a cement compound, it creates an ideal bonding slurry for application in demanding conditions or on difficult substrates.

APPLICATIONS:

- Ideal for use on concrete, cement compounds, plaster substrates, fast-drying screeds etc.
- For interior and exterior use.

BENEFITS:

- Odourless and solvent-free
- With pigment for identification of treated surfaces
- For floor heating systems
- Can be diluted with water up to the proportion of 1:5
- For walls and floors
- Application with a roller or brush

TECHNICAL PARAMETERS:

- Coverage/ layer: 0,04–0,1 l/m², depending on absorption of the substrate and mixing ratio
- Application temperature: min +15°C
- Drying time at +20°C/ 50% r.h.: ca. 10–30 min
- Drying on plaster substrates: 24 h to create a separation layer

Product name	Content	Packaging	Pieces per pallet
WB-290	10 l	Canister	60

EB-270

Epoxy Primer



This epoxy primer is ideal for preparation of substrates with increased residual moisture ≤ 4,0% cm. Can be diluted with water (up to 1,5 l), according to the type of application.

APPLICATIONS:

- Can be applied on absorbent, non-absorbent and smooth substrates, vertical and horizontal surfaces
- For interior and exterior use

TECHNICAL PARAMETERS:

- Working time: up to 2 h
- Ready for foot traffic: 30–60 min
- Coverage: 0,2–0,35 kg/m² with two-layer coating

BENEFITS:

- Forms an ideal contact layer in connection
- With silica sand
- Free of solvents according to TRGS 610
- For floor heating systems
- Excellent penetration into the substrate
- High spreading rate
- Easy application using a roller or brush

Product name	Content	Packaging	Pieces per pallet
EB-270	3,5 kg	Bucket	45



ARTELIT PRIMERS	WB-280	WB-290	EB-270
CHEMICAL BASE	DISPERSION	DISPERSION	EPOXY
Consumption (kg/m ²) *	0,1–0,13	0,05–0,08	0,2–0,25 (0,35 without water)
Density (g/m ³)	1,3	1,04	1,1
Drying time	30–60 min	10–30 min	30–60 min
Application of next layers	30–60 min	10–30 min	after 24 h
TECHNICAL FEATURES			
Number of layers	1	1	2
Dilute with water	no	yes, 1:3 or 1:5	yes, max 2 l for one package**
Sanding with silica sand	no	no	yes
Colour	turquoise	blue	green
TYPE OF SUBSTRATE			
Absorbent			
Non absorbent			
Bitumen			
Concrete			
Rapid screed			
Terazzo			
Cement levelling screed			
Anhydrite screed			
Wooden			
Ceramic tiles			
Natural stone			
OSB, chipboard V 100			
Residues of synthetic adhesives			
Tightly glued PVC, CV, rubber, linoleum			
Steel and other metals			
Magnesite			
Underfloor heating			
ENVIRONMENT			
Areas with high or permanent humidity			
Substrates with high humidity (<4%)			
Interior			
Exterior			
Wall and floor			

* depends on the absorbency of the substrate

** only on absorbent substrates

RECOMMENDED

**CONDITIONALLY
RECOMMENDED**

**NOT
RECOMMENDED**

RC-001

Emergency Repair Compound

Emergency Repair Compound based on polyester resin. The packaging includes metal clips for reinforcing of the seam and a hardener for adjustment of the working time.



APPLICATIONS:

- Ideal for stitching of concrete, filling cracks, fissures and holes in cement screeds and concretes.
- Anchoring of metal parts, natural and artificial stone
- Installation of wooden floor boards (together with nails)
- Note: for repairing of fissures in bitumen substrates, we recommend using polyurethane compound PB-985
- For interior and exterior areas

TECHNICAL PARAMETERS:

- Working time: up to 20 min
- Possibility of full loading: after 30–60 min
- Coverage: 1,5 kg/m²
- Temperature resistance: < +50°C

BENEFITS:

- Water-free
- For floor heating systems
- For high loads

Product name	Content	Packaging	Pieces per box	Pieces per pallet
RC-001 Emergency Repair Compound	300 ml + 300 ml	Bottle	10	390

LC-700

Sturdy Levelling Compound for Repairs

Very strong levelling compound recommended for repairs and smoothing of interior subfloors.



APPLICATIONS:

- Repairs of fissures
- Levelling and smoothing of the substrate
- Correcting min or unevenness and holes
- Up to 10 mm
- For interior use

TECHNICAL PARAMETERS:

- Working time: ca. 15 min
- Ready for foot traffic: ca. 30 min
- Ready for covering: after 4 h
- Coverage: ca. 1,5 kg/m²/mm
- Pressure strength: < 25,0 MPa
- Tensile strength under bending: < 7,0 MPa

BENEFITS:

- High hardness and strength
- Minimum internal stress
- For floor heating systems
- Suitable for caster wheel load (in case of layers thicker than 2 mm)

Product name	Content	Packaging	Pieces per pallet
LC-700 Sturdy Levelling Compound for Repairs	25 kg	Bag	42

LC-702

Liquid Levelling Compound

Ready-to-use levelling compound for immediate application. Forms a levelling layer of 2–3 mm.

APPLICATIONS:

- Levelling and smoothing of local unevenness prior to the installation of thin elastic flooring
- For interior use – minimal shrinking

TECHNICAL PARAMETERS:

- Technical parameters:
- Ready for covering: ca. 48 h
- Coverage: ca. 1,5 kg/m²/mm

BENEFITS:

- For fast application
- Contains mould-preventing additives



Product name	Content	Packaging	Pieces per pallet
LC-702 Liquid Levelling Compound	17 kg	Bucket	44

LC-705

Self-Levelling Compound up to 5 mm

Fast-drying, self-levelling, thin-layer mixture suitable for levelling unevenness up to 5 mm.

APPLICATIONS:

- Levelling of substrates before installation of elastic flooring, such as PVC, linoleum, carpets or cork tiles
- Ideal for vinyl components
- For interior use

TECHNICAL PARAMETERS:

- Working time: ca. 30 min
- Ready for foot traffic: ca. 3 h
- Ready for covering: ca. 24 h
- Coverage: ca. 1,5 kg/m²/mm
- Pressure strength: < 20,0 MPa
- Tensile strength under bending: < 6,1 MPa

BENEFITS:

- Very hard and strong
- Minimal internal stress
- Possible application by pump
- For floor heating systems
- Suitable for caster wheel load (in case of layers thicker than 2 mm)



Product name	Content	Packaging	Pieces per pallet
LC-705 Self-Levelling Compound up to 5 mm	25 kg	Bag	48



LC-710

Classic Self-Levelling Compound up to 10 mm

Fast-drying, self-levelling, thin-layer compound suitable for levelling unevenness up to 10 mm.



APPLICATIONS:

- Levelling of the substrate before installation of flooring, such as PVC, carpet, cork, linoleum or parquets
- For interior use

BENEFITS:

- Very hard and strong
- Minimal internal stress
- Possible application by pump
- For floor heating systems
- Suitable for caster wheel load (in case of layers thicker than 2 mm)

TECHNICAL PARAMETERS:

- Working time: ca. 30 min
- Ready for foot traffic: ca. 3 h
- Ready for covering: ca. 24 h (with 5 mm layer) or 48 h (with 10 mm layer)
- Coverage: ca. 1,5 kg/m²/mm
- Pressure strength: < 20,0 MPa
- Tensile strength at bending: < 6,1 MPa

Product name	Content	Packaging	Pieces per pallet
LC-710 Classic Self-Levelling Compound up to 10 mm	25 kg	Bag	48

LC-720

Anhydride Self-Levelling Compound up to 20 mm



This self-levelling anhydride-based compound is especially designed for use on anhydride screeds, however, it can also be applied on cement, bitumen and wooden substrates.

APPLICATIONS:

- Optimal for all types of flooring, including parquets
- For interior use only

BENEFITS:

- Very low emission EC1
- Minimal internal stress
- Possible application by pump
- For floor heating systems
- Suitable for caster wheel load (in case of layers thicker than 1,5 mm)

TECHNICAL PARAMETERS:

- Working time: ca. 30 min
- Ready for foot traffic: ca. 3 h
- Ready for covering: ca. 24 h (with the thickness of 5 mm), value 0,5% cm
- Coverage: ca. 1,5 kg/m²/mm
- Pressure strength: < 36,7 MPa
- Tensile strength at bending: < 11,9 MPa

Product name	Content	Packaging	Pieces per pallet
LC-720 Anhydride Self-Levelling Compound up to 20 mm	25 kg	Bag	42

LC-735

Cement Screed up to 35 mm



LC-735 Cement Screed ensures a smooth substrate prior to the installation of all types of floor coverings. Contains fiber for higher flexibility and durability.

APPLICATIONS:

- Under textile carpets, PVC, parquets, ceramic tiles and stone tiles
- Can be applied in areas temporarily exposed to increased humidity (bathrooms, kitchens, basements, garages)
- Can be used with electrical floor heating systems – the minimum thickness should be 25 mm

BENEFITS:

- Easy to apply
- Layer thickness 5–35 mm
- Suitable for floor heating systems

TECHNICAL PARAMETERS:

- Working time: approx. 20 min
- Ready for foot traffic: approx. 6 h
- Ready for covering: approx. 48 h
- Coverage: approx. 1,7 kg/m²/mm

Product name	Content	Packaging	Pieces per pallet
LC-735 Cement Screed up to 35 mm	25 kg	Bag	48

LC-760

Cement Screed up to 60 mm



LC-760 Cement Screed is recommended for surfaces which require rougher levelling. Forms a layer from 3 to 60 mm thick. Due to the minimal ratio of mixing with water (only 4,5 l/ 25 kg of dry mixture), it has very low shrinkage rate and excellent properties.

APPLICATIONS:

- For interior and exterior use
- Optimal for levelling of concrete, cement screeds, bitumens cat. IC 10 and IC 15 according to DIN 18 354 and DIN 18 560

BENEFITS:

- Very low emissions
- Resistant against freezing and water
- Minimal volume changes
- Suitable for floor heating systems
- Sand can be added without reducing strength
- Possible application by pump
- Suitable for caster wheels
- Low content of chrome

TECHNICAL PARAMETERS:

- Working time: ca. 40 min at +18°C
- Application temperature: +5 to +25°C
- Pressure strength: > 35 MPa
- Ready for foot traffic: after ca. 4 h
- Ready for covering: after 24 h with the layer thickness up to 10 mm
- Coverage: ca. 1,7 kg/m²/mm

Product name	Content	Packaging	Pieces per pallet
LC-760 Cement Screed up to 60 mm	25 kg	Bag	42





WB-965

Carpet Adhesive

Dispersion adhesive free of organic solvents. It is designed for all absorbent substrates in interiors, such as concrete, levelling compounds, wooden chip board, wooden floors etc. In order to increase adhesion, we recommend using Artelit primer WB-290 or WB-291.



APPLICATIONS:

- Bonding of textile lining with synthetic or jute-fibre back face, with latex or foam back face, as well as other types of textile lining (coconut, sisal, hemp fibre)
- Bonding of PVC lining with textile base in public utility and residential areas
- Bonding of mineral wool on all absorbent substrates

TECHNICAL PARAMETERS:

- Vaporization time: ca. 10 min
- Working time: up to 20 min (at +20°C)
- Full loading: after 72 h
- Coverage: 0,4 kg/m² (A2 racking)
- 0,45–0,55 kg/m² (B1, B2 racking)

BENEFITS:

- Odour-free, smooth creamy consistence
- High initial bonding strength
- Resistant against shampooing
- Suitable for floor heating systems and caster wheels
- Fast and easy application
- Short time of vaporization

Product name	Content	Packaging	Pieces per pallet
WB-965 Carpet Adhesive	20 kg	Bucket	33

WB-975

PVC Adhesive

Dispersion adhesive designed for horizontal and vertical surfaces. The adhesive has very good adhesion to common absorbent construction substrates, such as concrete, cement substrates, anhydride- and cement-based levelling compounds. In order to increase adhesion, we recommend using Artelit primer WB-290 or WB-291.



APPLICATIONS:

- Bonding of floor coverings made of PVC and CV
- Bonding textile lining with foam base – smooth or embossed, with latex layer or PU base
- For interior use

TECHNICAL PARAMETERS:

- Vaporization time: ca. 10–15 min
- Working time: 60–70 min (at +20°C)
- Final strength: after 72 h
- Coverage: 0,3–0,35 kg/m² (A1–A4 racking)

BENEFITS:

- High initial bonding power
- Long open time
- Suitable for floor heating systems and chair casters
- Fast and easy application
- Short time of vaporization
- Solvent-free

Product name	Content	Packaging	Pieces per pallet
WB-975 PVC Adhesive	20 kg	Bucket	33

WB-976

Linoleum Adhesive

Special dispersion adhesive for linoleum floor coverings.

APPLICATIONS:

- Bonding of rolled linoleum and cork linoleum
- For interior use

BENEFITS:

- High bonding power
- Strong fibre tension
- Suitable for floor heating systems and chair casters
- Fast and easy application
- Very short time of vaporization

TECHNICAL PARAMETERS:

- Vaporization time: ca. 5 min
- Working time: 20 min (at +20°C)
- Final strength: after 72 h
- Coverage: 0,4 kg/m² (B1 racking)



Product name	Content	Packaging	Pieces per pallet
WB-976 Linoleum Adhesive	20 kg	Bucket	33

WB-977

Conductive Adhesive for Floor Coverings

Unique dispersion adhesive free of organic solvents, suitable for bonding of flooring with electrostatically conductive or antistatic treatment on all common absorbent substrates. It is not necessary to use a conductive primer. High content of carbon fibres ensures strong conductivity and facilitates assembling – only 1 common metre of copper strip is required for 30–50 m².

APPLICATIONS:

- Bonding of flooring with electrostatically conductive or antistatic treatment made of PVC, synthetic rubber and linoleum
- For interior use

BENEFITS:

- High bonding power
- With strong fibre tension
- Suitable for floor heating systems and chair casters
- Very low rate of EC1 emissions
- Resistant against shampooing of flooring
- Resistant against softeners

TECHNICAL PARAMETERS:

- Vaporization time: ca. 10 min
- Working time: 30 min (at +20°C)
- Final strength: after 72 h
- Coverage: 0,4 kg/m² (B1 racking)
- Electrical resistance: < 3 x 10⁵ Ω according to DIN EN 14 259



Product name	Content	Packaging	Pieces per pallet
WB-977 Conductive Adhesive for Floor Coverings	14 kg	Bucket	44

WB-981

Special Universal Adhesive for Floor Coverings

A universal adhesive for elastic coverings, with excellent adhesion to all common absorbent substrates in interiors.



APPLICATIONS:

- Bonding of floor coverings made of PVC and CV, textile lining with foam base, smooth and embossed base, latex or PU layer
- Linoleum, cork coverings, coverings of natural and synthetic rubber
- Sound dampening mats
- Vinyl coverings

TECHNICAL PARAMETERS:

- Vaporization time: ca. 5 min
- Working time: 30 min (at +20°C)
- Final strength: after 72 h
- Coverage:
 - 0,25–0,35 kg/m² (A1–A4 racking)
 - 0,35–0,6 kg/m² (B1–B3 racking)

BENEFITS:

- High bonding power
- Suitable for floor heating systems and chair casters
- Fast and easy application
- Short time of vaporization
- Resistant against softeners

Product name	Content	Packaging	Pieces per pallet
WB-981 Special Universal Adhesive for Floor Coverings	20 kg	Bucket	32

WB-982

Universal Dispersion Adhesive for Floor Coverings

A universal solvent-free adhesive for floor coverings suitable for all common absorbent substrates in interiors.



APPLICATIONS:

- High bonding power
- Suitable for floor heating systems and chair casters
- Fast and easy application
- Short time of vaporization
- Resistant against softeners

TECHNICAL PARAMETERS:

- Vaporization time: ca. 5 min
- Working time: 30 min (at +20°C)
- Final strength: after 72 h
- Coverage:
 - 0,25–0,35 kg/m² (A1–A4 racking)
 - 0,35–0,6 kg/m² (B1–B3 racking)

BENEFITS:

- High bonding power
- Suitable for floor heating systems and chair casters
- Fast and easy application
- Short time of vaporization
- Resistant against softeners

Product name	Content	Packaging	Pieces per pallet
WB-982 Universal Dispersion Adhesive for Floor Coverings	20 kg	Bucket	32

WB-984

Fixing Adhesive

A removable adhesive which prevents carpets from slipping on the subfloor.

APPLICATIONS:

- Removable fixing of textile lining with various bases, CV coverings and anti-slip coating coverings
- For interior use

TECHNICAL PARAMETERS:

- Curing time for 1 layer: min 6 h
- Full curing time: min 24 h
- Min layer thickness: 1,5 mm
- Total consumption: 1,3–2,0 kg/m²

BENEFITS:

- For all common absorbent substrates
- Can be applied on smooth substrates by roller
- High bonding power
- Strong fibre tension
- Suitable for floor heating systems and chair casters
- Very low rate of EC1 emissions
- Can be mixed with up to 50% water to reduce adhesion
- Resistant against shampooing of coverings

Note: Once the covering is removed, adhesive can be easily removed by cleaning agents.



Product name	Content	Packaging	Pieces per pallet
WB-984 Fixing Adhesive	12 kg	Bucket	44

WB-986

Anti-Slip Fluid for Carpet Coverings

A special fluid which prevents carpets from slipping on the subfloor and enables their easy removal.

APPLICATIONS:

- Fixing carpet tiles
- Fixing sound dampening mats

TECHNICAL PARAMETERS:

- Time of vaporization: ca. 60 min
- Consumption on non-absorbent subfloors: 50–100 g/m²
- Consumption on porous subfloors: 100–150 g/m²
- Tools: Lambswool roller or brush

BENEFITS:

- For all common absorbent substrates
- Very low VOC emission
- Easy removal
- Favourable spreading capacity
- Permanent adhesion



Product name	Content	Packaging	Pieces per pallet
WB-986 Anti-Slip Fluid for Carpet Coverings	10 kg	Bucket	44

PB-985

2C PU Adhesive for Elastic Coverings

Two-component polyurethane-based adhesive for elastic coverings, also suitable for various applications in other construction works. Can also be used as a corrective filler for filling of cracks and holes in substrate (subsequent dressing by silica sand is necessary).



APPLICATIONS:

- Bonding of heavy-duty elastic coverings, especially PVC and rubber coverings
- Installation of artificial grass
- For interior and exterior use

BENEFITS:

- For all absorbent and non-absorbent substrates
- High bonding strength
- Suitable for floor heating systems and chair casters
- Fast and easy application
- Without volume changes even for thicker layers
- Solvent- and water-free

TECHNICAL PARAMETERS:

- Time of vaporization: immediate application
- Working time: 70 min (at +20°C)
- Final strength: after 72 h
- Coverage:
 - 0,2 kg/m² (A2 racking)
 - 0,5–1,0 kg/m² (B1–B3 racking)

Product name	Content	Packaging	Pieces per pallet
PB-985 2C PU Adhesive for Elastic Coverings	7,05 kg Adhesive	Bucket	60
	1,05 kg Hardener	Bottle	60

SB-510

Universal Contact Adhesive

A universal adhesive based on synthetic resins and rubber. Suitable for contact bonding during various flooring and construction works. The adhesive has very good adhesion to absorbent and non-absorbent surfaces. It does not contain toluene.



APPLICATIONS:

- Bonding metal, concrete, stone, plasterboard, PVC, rubber (gum), felt, cork, textile or leather
- For interior and exterior use

BENEFITS:

- Highly durable and permanently flexible bond
- Economical packaging
- Free of water
- For floor heating systems
- Fast and easy application

TECHNICAL PARAMETERS:

- Vaporization time: contact bonding – immediate application
- Working time: 25–45 min (at +20°C)
- Final strength: after 72 h
- Coverage: 0,2–0,3 kg/m²

Product name	Content	Packaging	Pieces per pallet
SB-510 Universal Contact Adhesive	5 l	Bucket	90



Artelit Professional Systems – Selected Solutions

	Description	Artelit Products	Recommendation
1	Anhydrite substrate	–	Sanding
2	Primer	WB-290	Mix with water in 1:1 ratio
3	Leveling compound	LC-720	Thickness 2–20 mm
4	Conductive adhesive	WB-977	For PVC, linoleum, carpet
5	Earthing	–	1 m of copper tape

Electrostatic flooring on anhydrite substrate

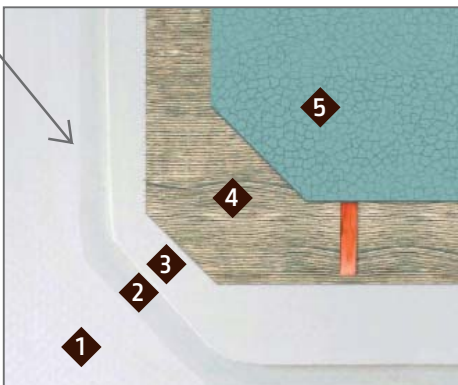

Parquet flooring on non absorbent substrate

	Description	Artelit Products	Recommendation
1	Concrete substrate	–	Sanding
2	Primer	EB-270	Sanding with silica sand or WB-280
3	Leveling compound	LC-760	3–30 mm, 40 MPa
4	2 C PU adhesive	PB-890	Working time up to 90 min
5	Parquet filler	FS-415	Mix with wooden dust
6	1 C primer varnish	S-460	First coat
7	1 C top varnish	PW-480	Top coats

	Description	Artelit Products	Recommendation
1	Wooden substrate	–	Wood, OSB, plywood
2	Primer	WB-280	–
3	Levelling compound	LC-720	Thickness 2–20 mm
4	Adhesive	WB-975	For PVC

PVC coverings on wooden substrate

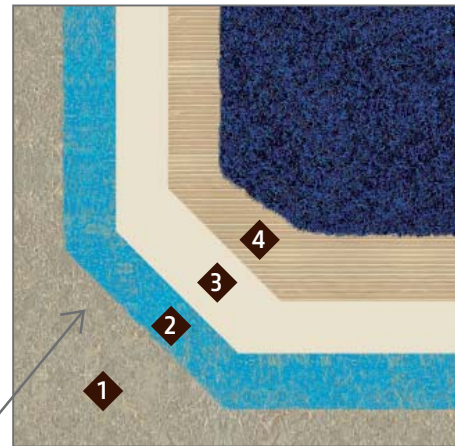
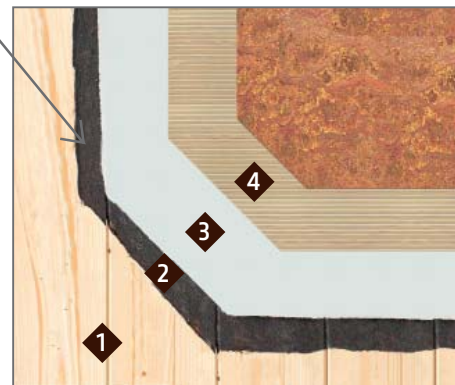

Elastic coverings on problematic substrates

	Description	Artelit Products	Recommendation
1	Concrete substrate with old adhesive residue	–	Water based adhesives
2	Primer	WB-280	–
3	Leveling compound	LC-720	Thickness 2–20 mm
4	Dispersion adhesive	WB-965	For textile coverings

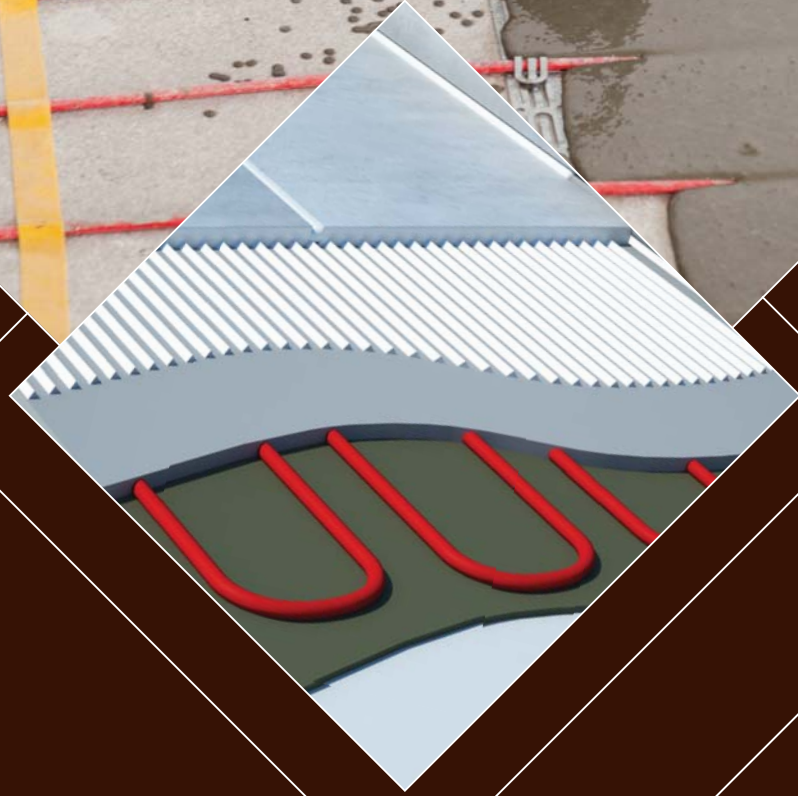
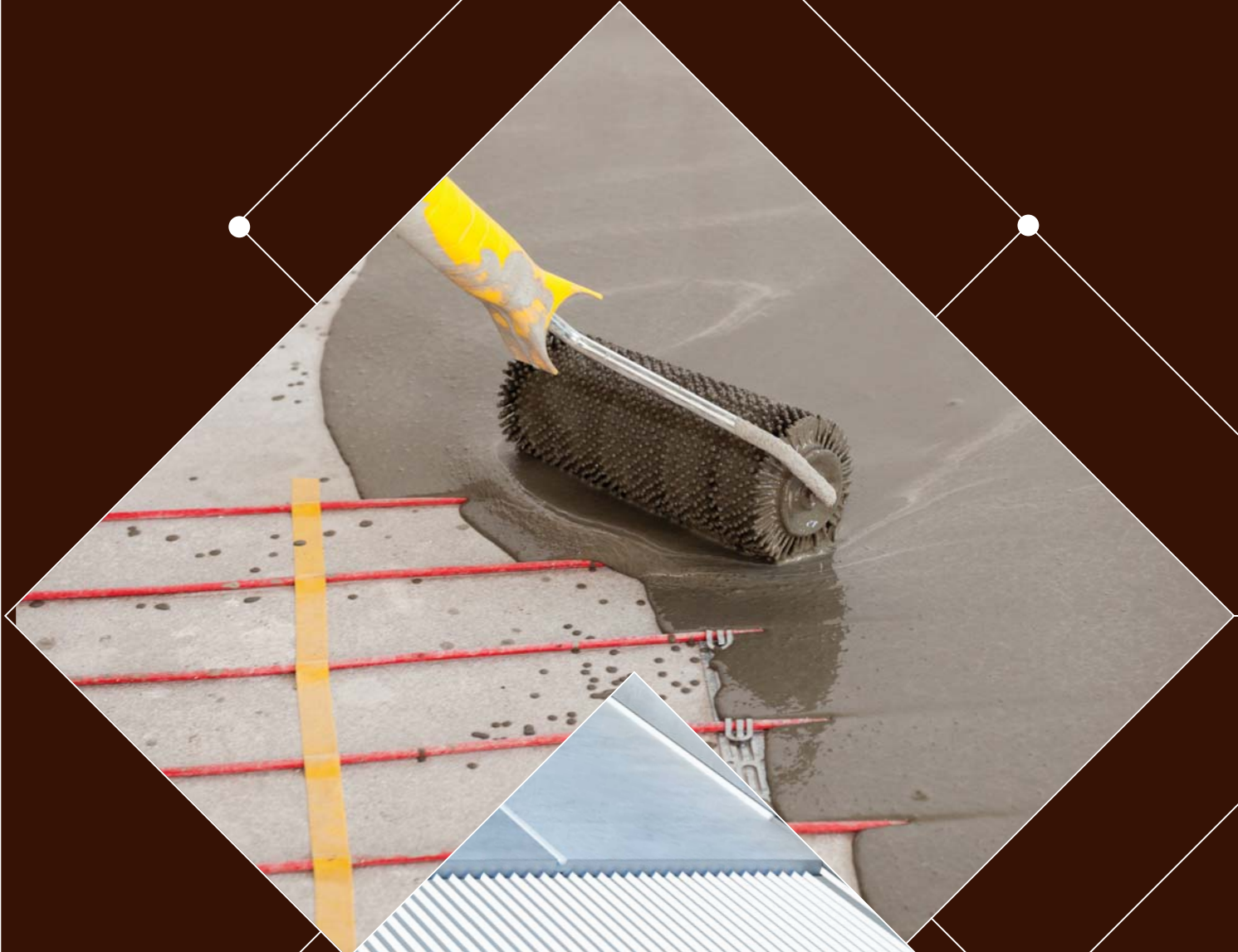

TILE SYSTEM FOR UNDERFLOOR HEATING

- 244 Maestra 10-80 Quick-Setting Screed
- 244 Marmurflex S1 White Adhesive with Trass
- 245 GEA746 Wide Tile Grout
- 245 Marble & Stone Silicone

Parquet Systems 199

Elastic Floor Covering Systems 221

Heated floors enjoy growing popularity. The materials dedicated for rendering under Heated Floor Systems are those which have high heat conduction ratio and which are resistant to increased temperature and its fluctuations. The material of choice here is ceramic or stone. The flooring rendered with the use of these materials has an additional advantage – the possibility of laying heating pipes or mats in the layer of adhesive which bonds the flooring to the substrate rather than in the primer. This shortens the distance that heat has to travel which makes the heating more effective.



Tile System for Underfloor Heating

How to choose proper adhesive for the underfloor heating?

Flooring adhesives are designed to provide a stable and strong bonding of tiles with its subfloor. The key factors to be considered here are: the type of substrate, the location of the floor, the load on the tile and its type. Wide tiles which enjoy growing popularity are exposed to a higher thermal stresses caused by temperature fluctuations as they are usually chosen for external decks and for the heated floors. This is why when choosing the right adhesive, such parameters as good adhesion or high flexibility have to be taken into account. The C2 S1 type adhesives have a proven record of high performance in heated floors due to their excellent capacity of eliminating air voids which are the main cause of the heat loss.

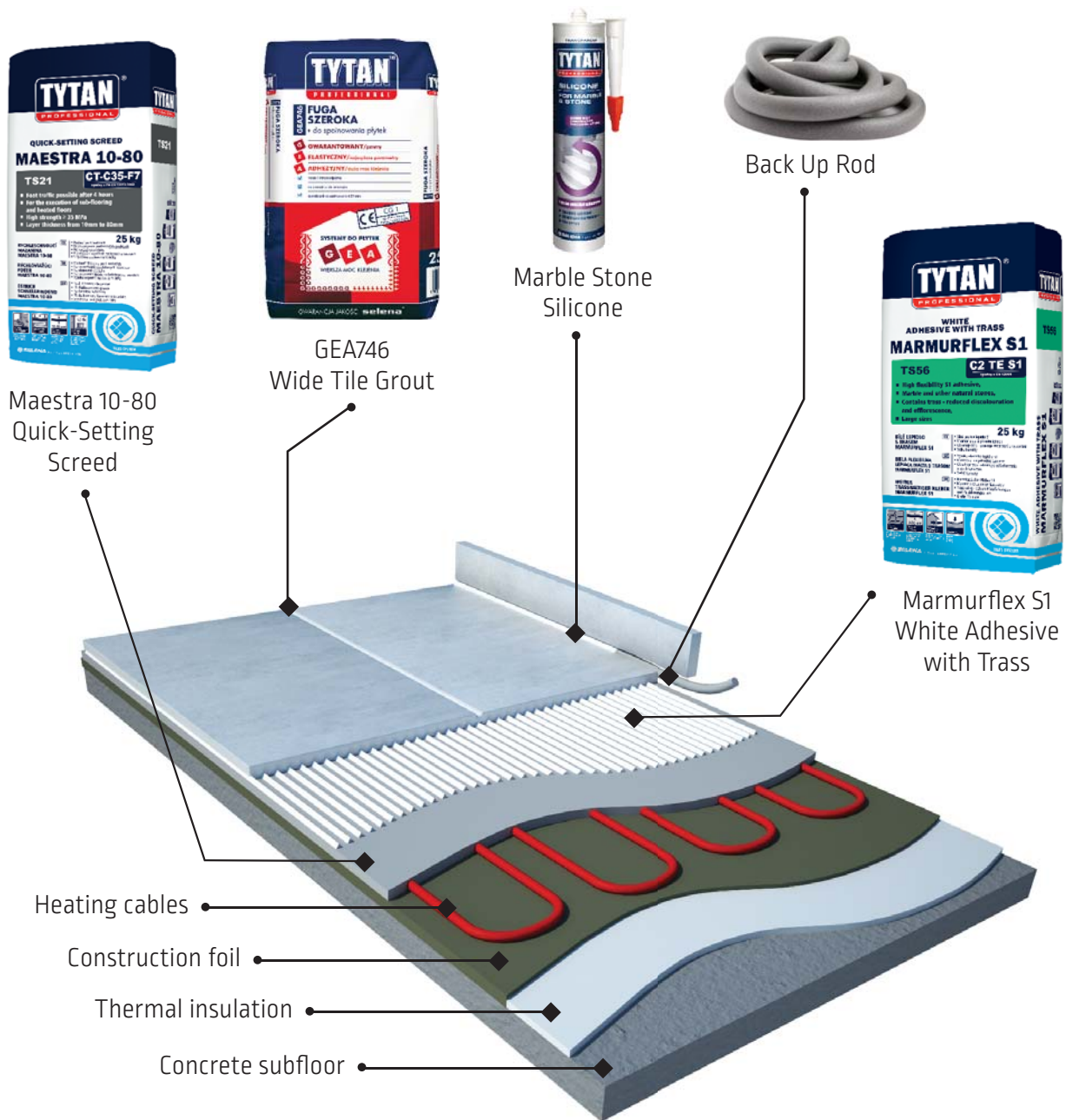

Maestra 10-80 Quick-Setting Screed



Maestra Quick-Setting screed is used for subflooring inside and outside of buildings. The screed is used as the final layer for flooring panels, ceramic tiles, floorings and epoxy resin paints, carpet flooring and as a primer for self-levelling compounds. Due to its consistency, it is ideal for forming slopes.

APPLICATIONS:

- For subflooring
- Heated floors
- Balconies and terraces
- For external and internal use

BENEFITS:

- Foot traffic possible after 4 h
- Quick curing – 80 mm layer ready for tiles installation after 24 h
- Layer thickness from 10–80 mm
- High strength ≥ 35 MPa
- Water and frost resistant

TECHNICAL PARAMETERS:

- Class: CT-C35-F7
- Application temperature: $+5^{\circ}\text{C}$ to $+25^{\circ}\text{C}$
- Mixing ratio: 2,75 l of water per 25 kg of dry mortar
- Pot life: ca. 15 min
- Allowed pedestrian traffic: after ca. 4 h
- Consumption: 2,0–2,2 $\text{kg}/\text{m}^2/\text{mm}$
- Bulk density: ca. 1,65 kg/dm^3
- Compressive strength: ≥ 35 MPa
- Flexural strength: ≥ 7 MPa
- Shrinkage: 1,25 mm/m
- Aggregate maximum diameter: 3 mm
- EN 13813:2003 CT-C35-F7

Product name	Content	Packaging	Pieces per pallet
Maestra 10-80 Quick-Setting Screed TS21	25 kg	Bag	48

Marmurflex S1 White Adhesive with Trass



White Adhesive with Trass Marmurflex S1 is suitable for efficient installation of all types of natural and synthetic marble, natural stone and ceramic floor tiles, terrazzo and cement tiles in all formats. The adhesive is designed for application onto virtually any rigid and demanding (difficult) substrate.

APPLICATIONS:

- Natural and synthetic marble
- Natural stones
- Ceramic floor tiles: glazed, terracotta, clinker, mosaics
- Terrazzo and cement tiles
- For underfloor heating
- For internal and external use

BENEFITS:

- For XXL format of tiles
- White colour – perfect for marble and other natural stones
- Contains trass – reduced discolouration and efflorescence
- For underfloor heating

TECHNICAL PARAMETERS:

- Mixing ratio: 6,5–7,0 l of water per 25 kg of dry mortar
- Mortar ready-for-use time after mixing with water: up to 3 h
- Application temperature: $+5^{\circ}\text{C}$ to $+25^{\circ}\text{C}$
- Open time (skin formation): 30 min
- Correction time: 30 min
- Grouting walls/ floors: after 12/ 24 h
- Partial/ full usage: after 3/ 14 days
- Slip: $\leq 0,5$ mm
- Approximate consumption for at the thickness of 1 mm: approx. 1,4 kg/m^2
- Layer thickness 2–20 mm
- EN 12004 C2 TE S1

Product name	Content	Packaging	Pieces per pallet
Marmurflex S1 White Adhesive with Trass TS56	25 kg	Bag	48

GEA746

Wide Tile Grout



Wide Tile Grout is designated for grouting joints of 4–20 mm width on walls and floors. Thanks to specially well-chosen high-class cement compositions the product is characterized by high resistance and adhesion as well as by very good application parameters such as resistance to cracking and scratching. High technical parameters of the product allow use on renewable substrates.

APPLICATIONS:

- Wide and rustic welds
- Floors exposed to large dirt
- Heated floor
- For external and internal use
- Terracotta, clinker, gres, mosaic
- Terazzo and cement tiles, plates from natural and synthetic stone
- Heavily loaded floors (offices, shops, schools, offices)

BENEFITS:

- Water and frost resistant
- For external and internal use
- Bathrooms, kitchens, halls, corridors, stairs
- Balconies and terraces
- Joint width: 4–20 mm
- Colours: white, grey, creamy, brown, graphite, black

TECHNICAL PARAMETERS:

- Mixing ratio
 - 5,0–5,5 l of water per 25 kg of dry mortar
 - 0,20–0,22 l of water per 1 kg of dry mortar
- Pot life up to 2 h
- Application temperature: +5°C to +25°C
- Set time: 48 h (walk on), 14 days (full cure)
- Min. joint width 4 mm
- Max. joint width 20 mm
- EN 13813 CG 1



Product name	Content	Packaging	Pieces per pallet
GEA746 Wide Tile Grout	25 kg	Bag	48

Marble & Stone Silicone

Flexible and durable sealant designed for stone work. Due to its neutral curing formula and the lack of any solvents, the product does not discolour natural stone and is safe for sensitive substrates, such as copper or mirror silver. Resistant to changing weather conditions, UV radiation and high temperature differences.



APPLICATIONS:

- Pointing joints and filling expansion joints in marble, granite or stone floors
- Sealing sinks with stone tops
- Pointing joints around mirrors
- Bonding mirrors to the wall

BENEFITS:

- Does not discolour natural stone
- Excellent adhesion
- UV and weather resistant
- Fast curing

TECHNICAL PARAMETERS:

- Colour: transparent
- System of curing: neutral

Product name	Content	Packaging	Pieces per box	Pieces per pallet
Marble & Stone Silicone	310 ml	Cartridge	12	1 440



WATCH
SELENA VIDEO:



HEADQUARTERS: Selena FM S.A.
ul. Strzegomska 2-4, 53-611 Wrocław, Poland
tel. + 4871 78 38 290, fax. + 4871 78 38 291

www.selena.com